

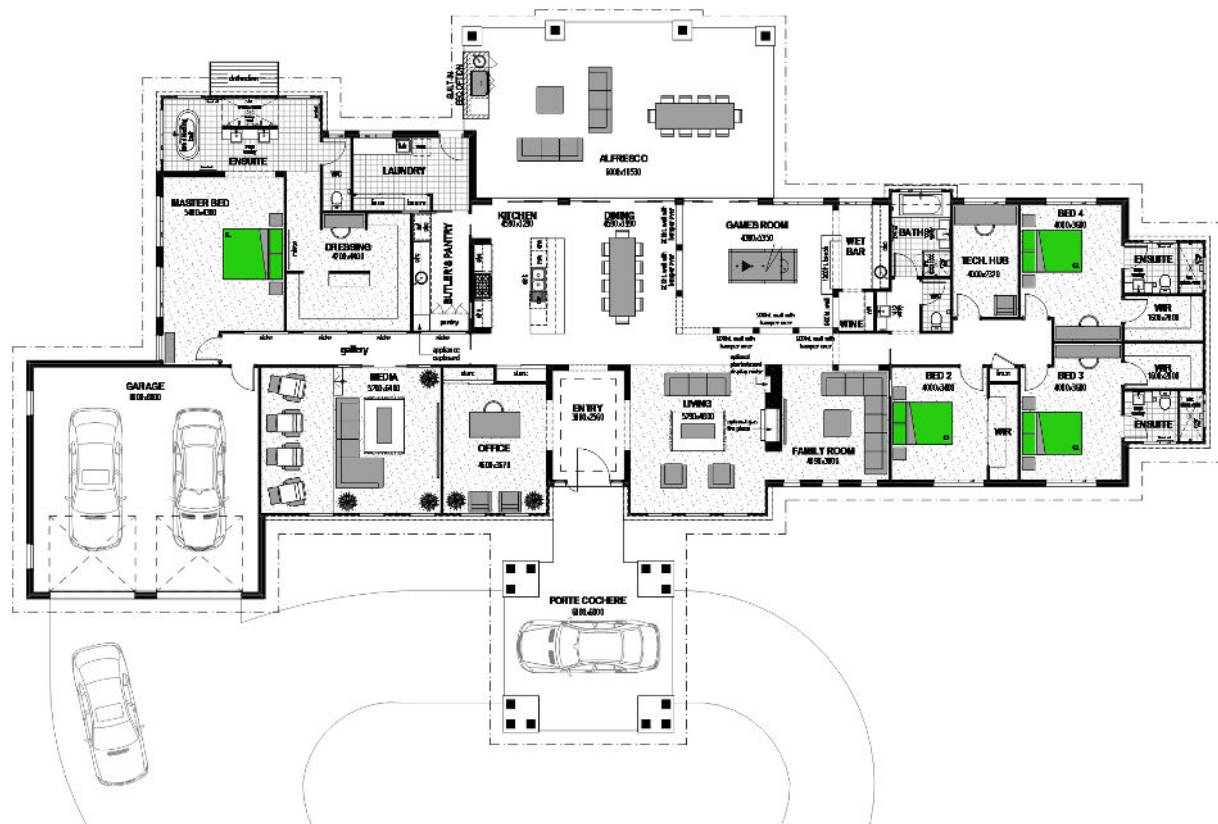

4 BED - 4 BATH - 3 CAR - MEDIA - OFFICE - GAMES ROOM - TECH HUB  
DRESSING ROOM - WET BAR - FAMILY ROOM

MOUNTAIN FACADE

# KORU 600 GRANDE



## Floor Area

Porte Cochere	48.00m <sup>2</sup>	Width	42.08m
Alfresco	66.78m <sup>2</sup>	Length	25.23m
Garage	69.71m <sup>2</sup>		
Living	417.22m <sup>2</sup>	Typical Frontage	45.08m+
<b>TOTAL</b>	<b>(64.77 sqs) 601.71m<sup>2</sup></b>	Dimensions shown are for Mountain Façade.	