

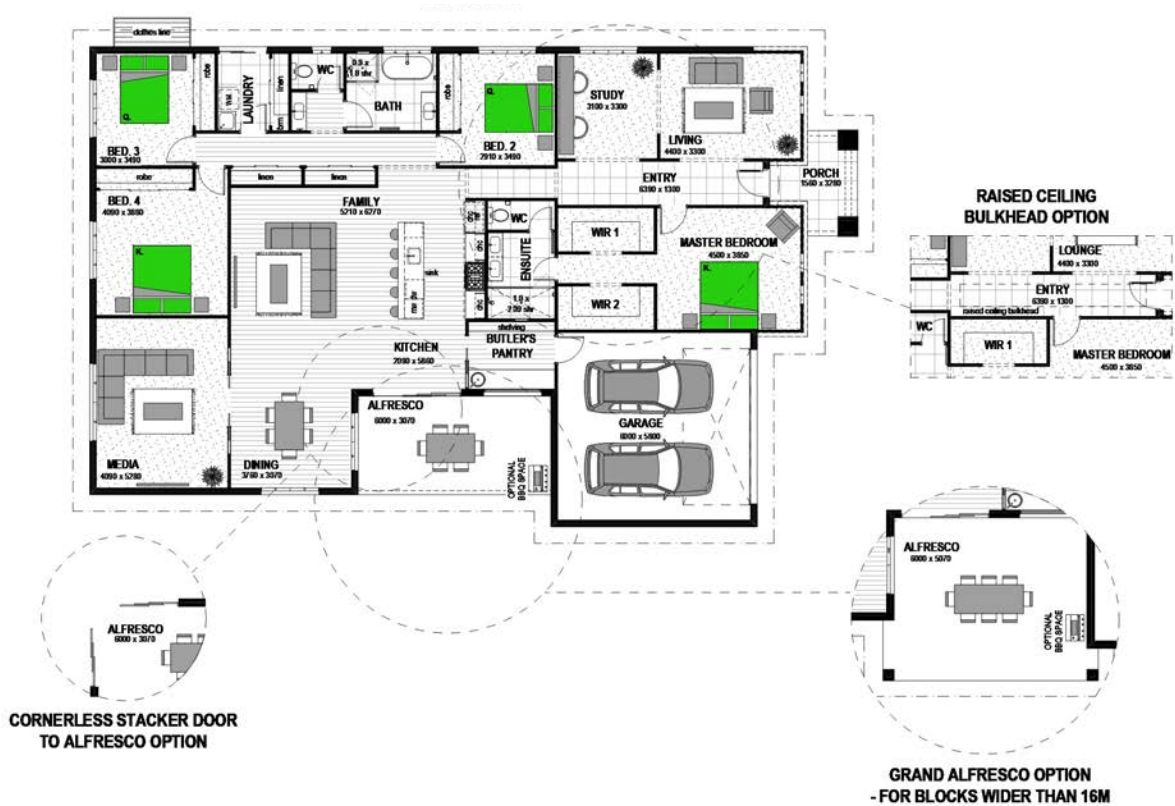

4 BED - 2 BATH - 2 CAR - MEDIA - STUDY - LIVING ROOM

ALPINE FACADE

TECOMA 318



Floor Area

Porch	6.23m ²	Width	14.94m
Garage	38.67m ²	Length	23.90m
Alfresco	18.85m ²		
Living	254.44m ²	Typical Frontage	17.94m+
TOTAL	(34.24sqs) 318.19m²	Dimensions shown are for Alpine Façade.	