

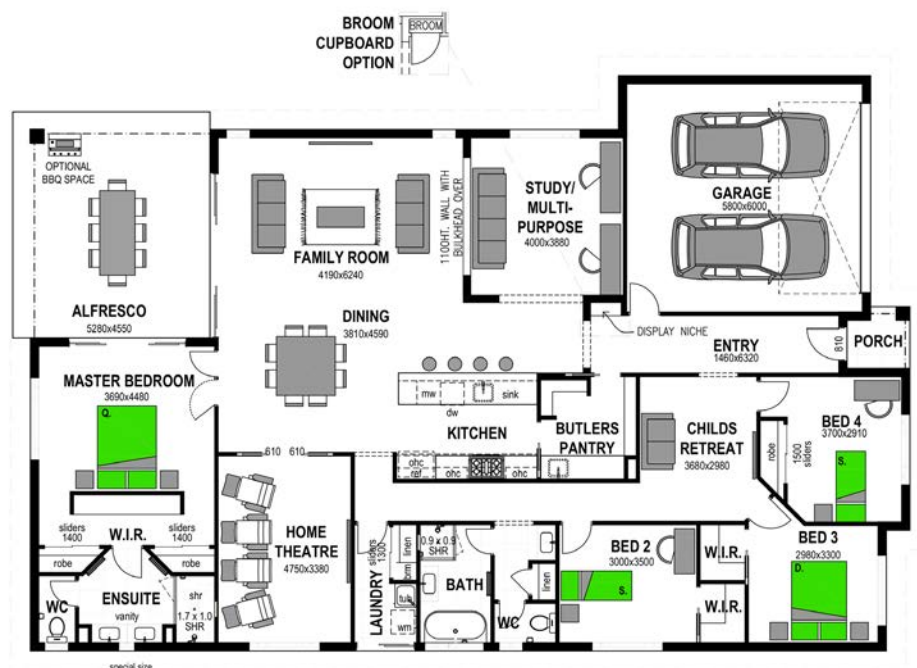

Mountain Façade

4 2 2

# Milford 300



## Floor Areas

Porch	2.3m <sup>2</sup>
Alfresco	24.2m <sup>2</sup>
Garage	37.9m <sup>2</sup>
Living	235.7m <sup>2</sup>
<b>TOTAL</b>	<b>(32.3sqs) 300.1m<sup>2</sup></b>
Width	14.6m
Depth	22.4m

Floor plan and dimensions shown are for the Classic Façade.

## Features



Media



Study



Child's Retreat



Walk-In Pantry



Alpine Façade



Classic Façade



Portico Façade



Coast Façade



Skillion Façade

More Façades available. Speak with our team or see [www.stroudhomes.co.nz](http://www.stroudhomes.co.nz) to see the full range.